

2ND AVENUE

BLACKTOWN



LEVEL 2

-  ONE BEDROOM
-  TWO BEDROOM
-  THREE BEDROOM
-  STAGE 2 ONE BEDROOM
-  STAGE 2 TWO BEDROOM



Disclaimer: Landmark Group does not guarantee, warrant or represent that the information contained in this advertising and marketing document is correct. Any interested parties should make their own enquiries as to the accuracy of the information. We exclude all inferred or implied terms, conditions and warranties arising out of this document and any liability for loss or damage arising there from. Furniture not included.

2ND AVENUE BLACKTOWN



LEVEL 3-6

-
- ONE BEDROOM
- TWO BEDROOM
- THREE BEDROOM
- STAGE 2 ONE BEDROOM
- STAGE 2 TWO BEDROOM



NORTH



Disclaimer: Landmark Group does not guarantee, warrant or represent that the information contained in this advertising and marketing document is correct. Any interested parties should make their own enquiries as to the accuracy of the information. We exclude all inferred or implied terms, conditions and warranties arising out of this document and any liability for loss or damage arising there from. Furniture not included.

2ND AVENUE

BLACKTOWN



LEVEL 7-10

-  ONE BEDROOM
-  TWO BEDROOM
-  THREE BEDROOM
-  STAGE 2 ONE BEDROOM
-  STAGE 2 TWO BEDROOM

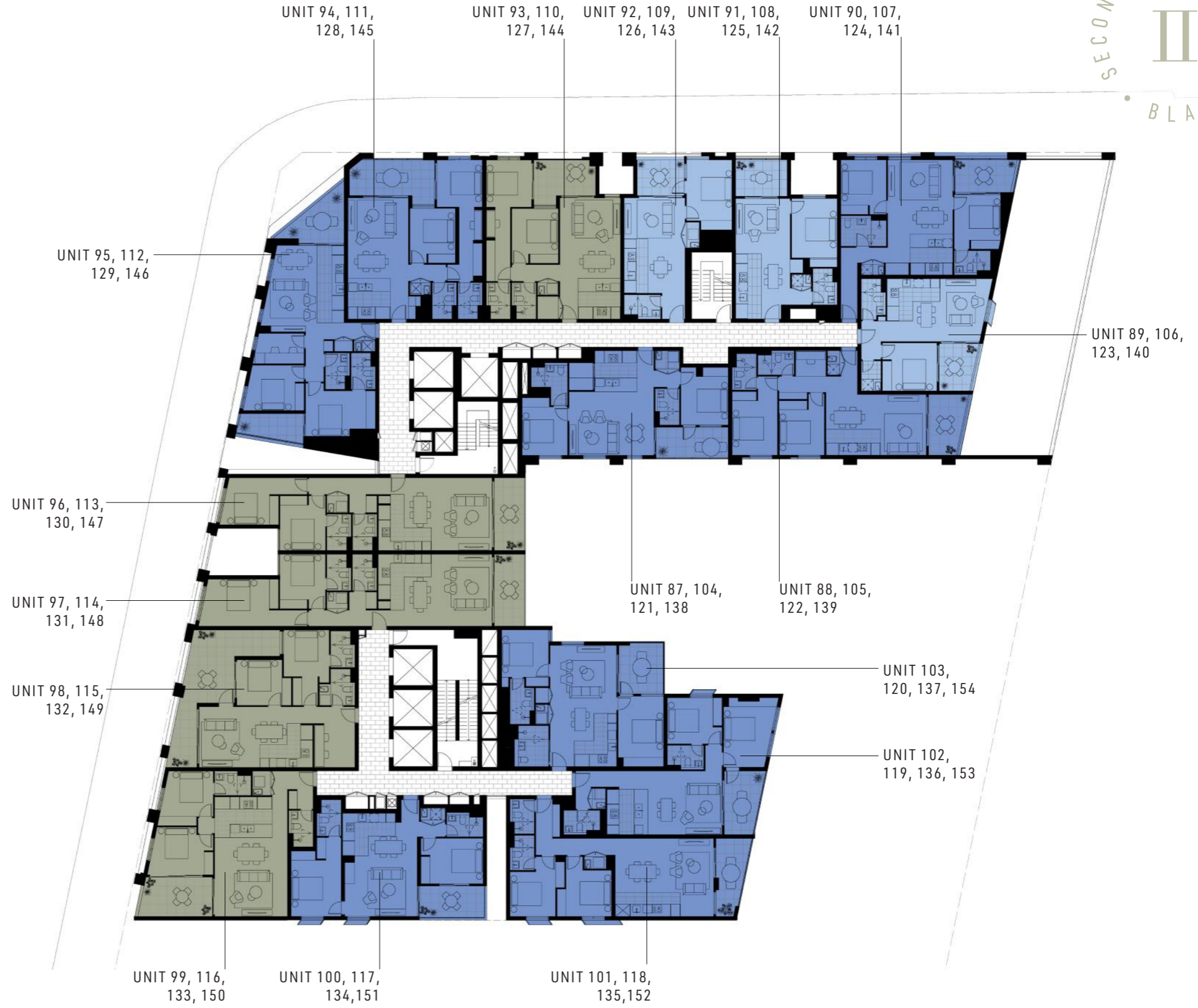

Disclaimer: Landmark Group does not guarantee, warrant or represent that the information contained in this advertising and marketing document is correct. Any interested parties should make their own enquiries as to the accuracy of the information. We exclude all inferred or implied terms, conditions and warranties arising out of this document and any liability for loss or damage arising there from. Furniture not included.

2ND AVENUE BLACKTOWN



LEVEL 11-14

-
- ONE BEDROOM
- TWO BEDROOM
- THREE BEDROOM
- STAGE 2 ONE BEDROOM
- STAGE 2 TWO BEDROOM



Disclaimer: Landmark Group does not guarantee, warrant or represent that the information contained in this advertising and marketing document is correct. Any interested parties should make their own enquiries as to the accuracy of the information. We exclude all inferred or implied terms, conditions and warranties arising out of this document and any liability for loss or damage arising there from. Furniture not included.

2ND AVENUE BLACKTOWN



LEVEL 15-17

-
- ONE BEDROOM
- TWO BEDROOM
- THREE BEDROOM
- STAGE 2 ONE BEDROOM
- STAGE 2 TWO BEDROOM



NORTH



Disclaimer: Landmark Group does not guarantee, warrant or represent that the information contained in this advertising and marketing document is correct. Any interested parties should make their own enquiries as to the accuracy of the information. We exclude all inferred or implied terms, conditions and warranties arising out of this document and any liability for loss or damage arising there from. Furniture not included.

2ND AVENUE BLACKTOWN



LEVEL 18-20

-
- ONE BEDROOM
- TWO BEDROOM
- THREE BEDROOM
- STAGE 2 ONE BEDROOM
- STAGE 2 TWO BEDROOM



Disclaimer: Landmark Group does not guarantee, warrant or represent that the information contained in this advertising and marketing document is correct. Any interested parties should make their own enquiries as to the accuracy of the information. We exclude all inferred or implied terms, conditions and warranties arising out of this document and any liability for loss or damage arising there from. Furniture not included.